

Renaissance Seoul Hotel

Discover one of the world's most interesting cities at the luxurious Renaissance Seoul Hotel. Our 5-star hotel in Seoul offers incredible amenities. All guest rooms feature luxurious bedding, in-room safe, high-speed Internet and individually controlled air-conditioning. Unwind with a cocktail or espresso at one of our many cafes. Choose from Steakhouse, Italian, Chinese and international cuisine at award-winning restaurants while catching up with colleagues or friends. Stay fit at the gym and take a dip in our indoor heated pool. Known for our conference facilities, we can accommodate up to 1,800 guests and dazzle them with unique catering and great service. Whether you're in Seoul for business or leisure, the Renaissance Seoul Hotel makes your stay memorable.

- Total area: 2,261m²
- No. of meeting rooms: 13
- Grade: SDL
- No. of guest rooms: 493
- Date of establishment: 1988
- From Incheon int'l Airport: 61min / 65.461 km
- A subway station: Line #2 Yeoksam Station

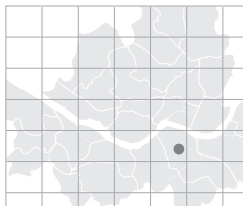

> Map: J-10 (p.019)

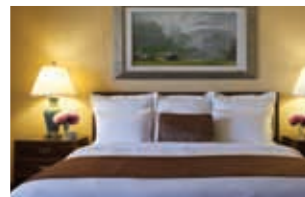
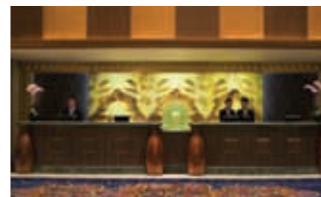

676 Yeoksam-dong, Gangnam-gu, Seoul, Korea
<http://www.renaissanceseoul.com>
rhi.selm.biz@renaissancehotels.com
rhi.selm.sales.center.mgr@renaissancehotels.com
 Tel: 82-2-555-0501 Fax: 82-2-553-8118

Person in Charge_HONG Sung-Wook
 Tel: 82-2-2222-8605
rhi.selm.dos@renaissancehotels.com

Special Features ① Separate Group Check-in Desk on the 3rd floor. ② Easy and convenient access from the business district of Seoul. ③ Broad parking lot and a separate parking place for large-sized buses. ④ Daily shuttle bus to Coex, Myeongdong and Itaewon (several times a day) ⑤ Marriott Rewards Points upon stay ⑥ Halal menu for group stay available upon request

Major Events ★12th World Conference of Lung Cancer (*Room only guests) - Sep. 2007 / 1,320guest rooms ★2008 RD Sub-region 3 Annual Meeting - Jan. 2008 / 500guests ★19th Conference of the APASL (*Room only guests) - Mar. 2008 / 2,050guest rooms ★The 13th Congress of the Asia, Psychosomatic Medicine - Aug. 2008 / 300guests ★Korea Society of Digestive - Mar. 2009 / 600guests ★Adobe Education Leadership Forum ASPAC - Apr. 2009 / 130guests

MEETING & BANQUET FACILITIES

Name of Hall	Location	Size(m ²)	Theater	Classroom	Cocktail	Banquet	Height(m)
Diamond Ballroom- I, II, III	3F	920	900	600	1,000	700	5.7
Topaz	4F	228	150	80	150	100	2.7
Sapphire	4F	109	80	50	80	60	2.7
Ruby	4F	98	70	50	70	50	2.7
Ruby-Sapphire	4F	208	170	80	150	120	2.7
Opal	4F	98	70	50	70	50	2.7
Jade	4F	109	80	50	80	60	2.7
Jade-Opal	4F	208	170	80	150	120	2.7
Universal	4F	462	280	170	350	230	2.7
Lily	23F	41	20	12	20	15	6.7
Lotus	23F	46	20	16	25	20	6.7
Azalea	23F	46	20	16	25	20	6.7
Orchid	23F	46	20	16	25	20	6.7
Rose	23F	58	30	20	30	25	6.7
Tulip	23F	46	20	12	20	15	6.7



23F

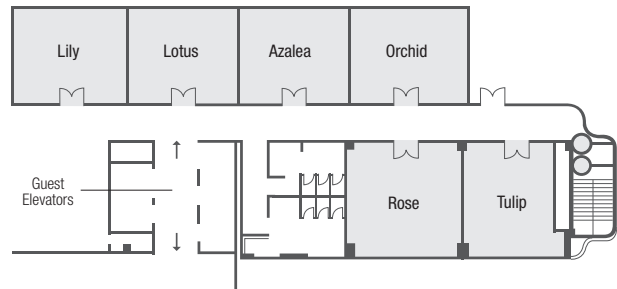

GUEST ROOMS

Room Type	Rooms
Guest Rooms	342
7F - 18F	
Deluxe	1
Korean Deluxe	1
Korean Suite	1
Superior Deluxe	24
Executive Deluxe	13
Corner Suite	9
Renaissance	86
Club Floor	
19F - 22F	
Deluxe	8
Executive Deluxe	2
Korean Suite	3
Corner Suite	2
Renaissance Suite	1
Royal Suite	1
Presidential Suite	1
Total	493
Single or Double	248
Twin	245

* Average Rates (Ordinary Rooms): KRW 180,000 - 312,000

FOOD & BEVERAGE

Name of Facility	Location	Cuisine	Capacity
Cafe's Elysee	Lobby FI	Buffet Restaurant	174
Manhattan Grill	Lobby FI	Steak House	116
Sabiru	1F	Korean	110
Irodori	3F	Japanese	125
Club Horizon	23F	Western	175

4F

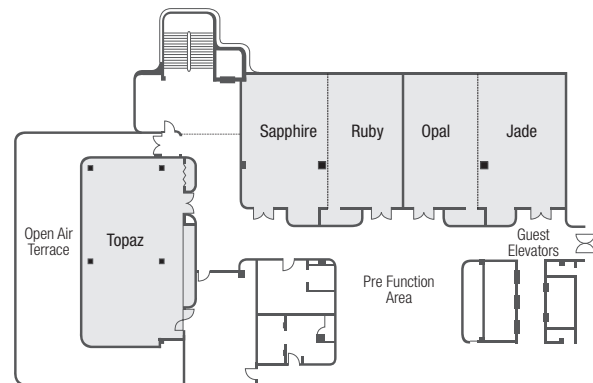

3F

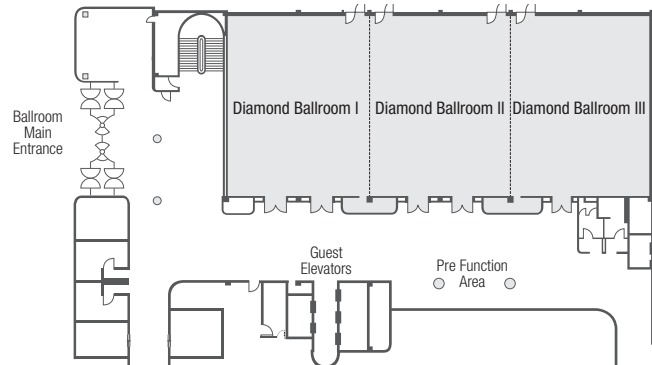

Nearby Attractions

• **Shopping:** Coex Mall, AK Duty Free Shop • **Entertainment:** LG Art Center *A tour program request upon concierge at the hotel.

> More info. p.146