

COEX Inter-Continental Seoul

Located adjacent to the Coex Convention and Exhibition Center, a casino and the Korea World Trade Center complex, the COEX InterContinental Seoul is a one-stop business and entertainment destination in the southern part of Seoul. Guests can conveniently access the City Air Terminal, duty free shop, Coex Mall with trendy shops, boutiques and 16 theaters. The COEX InterContinental Seoul is also located in this complex.

- Total area: 3,354m²
- No. of meeting rooms: 11
- Grade: SDL
- No. of guest rooms: 652
- Date of establishment: 1999
- From Incheon int'l Airport: 59min / 70.132 km
- A subway station: Line #2 Samsung Station

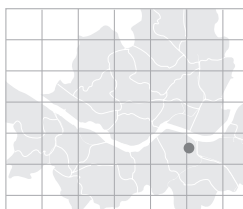

> Map: K-9 (p.019)



Special Features ① Banquet halls capable of from 15 to 1,500 guests. ② Close to Trade Center, Coex International Conference and Exhibition Centers and a city airport

Major Events ★Asia Petrochemical Industry Conference (Korea Petrochemical Industry Association) - May. 2005 / 500guests ★Int'l Society of Physical & Rehabilitation Medicine (Korean Academy of Rehabilitation Medicine) - Jun. 2007 / 2,000guests ★Symantec Asia Pacific Conference (Group Event Travel-GET) - Jul. 2007 / 500guests ★Int'l Asso. for the study of Lung Cancer (National Cancer Center) - Sep. 2007 / 2,000guests ★Asia Pacific Orthopaedic Association (Asia Pacific Orthopaedic Association (APOA) - Sep. 2007 / 1,000guests ★Human Proteom Organization (Korean Human Proteome Organization) - Oct. 2007 / 2,000guests ★P Assn for the Study of the Liver (The Korean Association for the Study of the Liver) - Mar. 2008 / 1,000guests ★OECD IT Minister Conference (Ministry of Information and Communication) - Jun. 2008 / 900guests ★World LP Gas Forum (World LP Gas Association) - Sep. 2008 / 600guests ★A.P Retailers Convention & Exhibition Korea (the Korea Chamber of Commerce and Industry) - Oct. 2009 / 1,000guests

3 Asem-gil, Gangnam-gu, Seoul, Korea

<http://www.seoul.intercontinental.com>

coexseoul@interconti.com

Tel: 82-2-3452-2500 Fax: 82-2-3430-8000

Person in Charge_Mr.Sam(Sang-ok) LEE

Tel: 82-2-559-7766

sangok_lee@interconti.com



MEETING & BANQUET FACILITIES

Name of Hall	Location	Size(m ²)	Theater	Classroom	Cocktail	Banquet	Height(m)
Harmony Ballroom	B1	938.6	1,000	600	1,000	600	5.6
Diamond Hall	B1	364	350	240	260	250	4.8
Moderato	B1	103	80	50	40	50	3.7
Vivace	B1	192.7	180	100	80	120	4.5
Andante	B1	85.4	50	36	20	40	4.5
Allegro	B1	193	180	100	80	120	4.5
Apollo	30F	75	50	30	40	30	3
Jupiter	30F	133	100	72	80	60	3
Venus	30F	83	40	30	22	40	3
Pluto	30F	24	-	-	-	12	9
Mercury	30F	58	30	20	20	16	3

30F

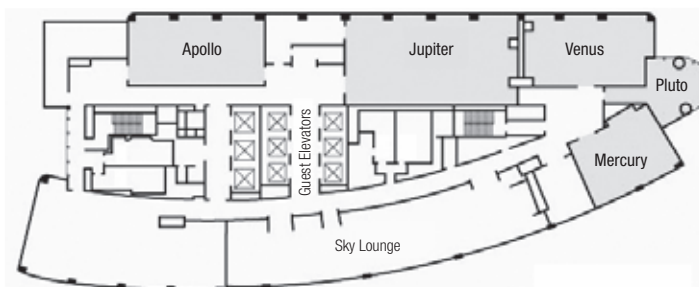

B1

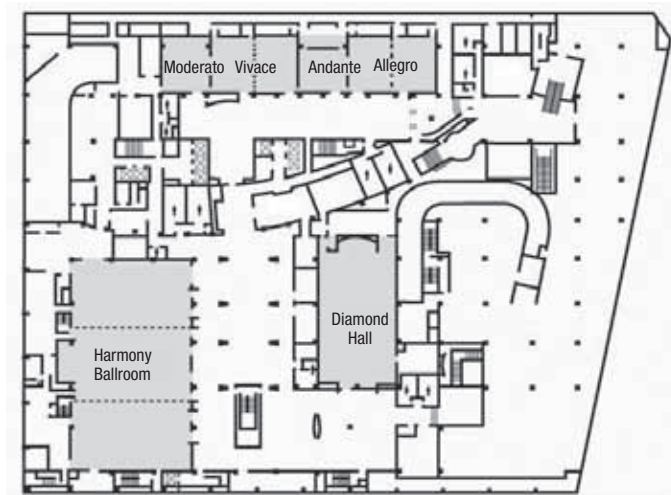

GUEST ROOMS

Room Type	Rooms
Superior Room	533
Business Room	81
Business Corner Suite	3
Commercial & Family Suite	10
Business Suite	1
Corner Suite	19
Ambassador Suite	1
Presidential Suite	1
Handicapped Room	2
Korean Room (Heated Floor)	1
Total	652
Single or Double	372
Twin	280

* Average Rates (Ordinary Rooms): KRW 160,000 - 260,000

FOOD & BEVERAGE

Name of Facility	Location	Cuisine	Capacity
Delibonbons	B2	A Large selection of home-made cakes & pastries	-
The Brasserie	1F	Buffet and a la carte menu	210
Lobby Lounge	1F	Coffee, Beverages and Light Snacks	120
Lobby Bar	1F	Wine & Cigar Bar	68
Asian Live	2F	Korea, China, Japan, India & Thailand	250
Sky Lounge	30F	Fine Cuisine	98

Nearby Attractions

• **Shopping:** Coex Mall, AK Duty Free Shop • **Entertainment:** LG Art Center, Coex Artium • **Sightseeing:** Coex Aquarium, Pulmuone Kimchi Museum

* A tour program offered by the hotel available (p. 154)

> More info. p.146