

The Shilla Seoul

Hosting numerous state visits and international events, The Shilla Seoul is consistently voted South Korea's top hotel by influential publications, most recently ranked among the 'World's Best Hotel's by Institutional Investor and 'World's Top 500 Hotel's by Travel + Leisure. In addition, it is a member of The Leading Hotels of the World. With stunning views of Mt. Namsan from a private 23-acre sculpture park in the heart of Seoul, The Shilla Seoul remains one of Asia's most admired hotel groups renowned for luxurious accommodation with state-of-the-art facilities.

- Total area: 27,733m²
- No. of meeting rooms: 13
- Grade: SDL
- No. of guest rooms: 462
- Date of establishment: 1979
- From Incheon int'l Airport: 60min / 62.346 km
- A subway station: Line #3 Dongguk Univ. Station

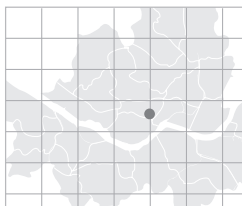

> Map: H-7 (p.019)



Special Features Combining first-class dining and event facilities, The Shilla Seoul is not to be overlooked for those planning conference and meetings or gala events in the South Korean capital. The Shilla's banquet rooms can transform any celebration into an elevated experience with a setting as remarkable as the cuisine.

Major Events ★International Forum to Host Pyeongchang Olympic Winter Games 2014 (IOC / Korea Sports Council) ★Guro-gu Electronic Forum 2007 (Seoul Metropolitan Government / Guro-gu Office) ★Chinese Prime Minister Wen Jiabao-invited Seminar to Attract Investment from China (Ministry of Foreign Affairs and Trade) ★2007 IT Ministers' Conference (Ministry of Information and Communication) ★FTA (Korea, U.S., EU, Canada, Mexico, India) (Ministry of Foreign Affairs and Trade / Ministry of Strategy and Finance / Ministry of Commerce, Industry and Energy) ★The Conference of the Foreign Ministers from Southeast Asian Countries (Ministry of Foreign Affairs and Trade) ★The Conference of the Ministers of Strategy and Finance from Korea / UAE (Ministry of Strategy and Finance) ★Manchester United Korea Tour 2009 (Manchester United F.C.) ★General Meeting of the Inter-Parliamentarians for Social Service (IPSS) (National Assembly) ★EXPO 2012 Yeosu Korea (Office of the Prime Minister / The Ministry of Maritime Affairs and Fisheries) ★OECD Ministers' Meeting (The Korea Development Institute) ★Posco Steel Conference (POSCO) ★General Meeting of the International Boy Scouts (International Boy Scouts Association) - Apr. 2008 / 600guests ★Asia Party Convention (National Assembly) ★ICGN Annual General Meeting (Korea Exchange) ★Kuwait Prime Minister-invited Seminar (Ministry of Foreign Affairs and International Cooperation) ★Chinese President Hu Jintao-invited Seminar (Ministry of Foreign Affairs and International Cooperation / Embassy of the People's Republic of China in the Republic of Korea) - Aug. 2008 / 500guests ★World Medical Assembly (Korean Medical Association) ★UBS IR Conference (UBS) ★KOTRA Conference (KOTRA) ★Investment Promotion Fair in Liaoning, China (Embassy of the People's Republic of China in the Republic of Korea) ★JP Morgan IR Conference (JP Morgan) ★Iraqi President's Visit to Korea (Ministry of Foreign Affairs and Trade / Embassy of Iraq in South Korea) ★Citi Forum (Citi Bank)

202 Jangchung-dong 2-ga, Jung-gu, Seoul, Korea

<http://www.shilla.net>
reserve@shilla.net

Tel: 82-2-2230-3131 Fax: 82-2-2230-5073

Person in Charge_JUNG Ha-Joon
 Tel: 82-2-2230-3491
hajoon.jung@samsung.com

MEETING & BANQUET FACILITIES

Name of Hall	Location	Size(m ²)	Theater	Classroom	Cocktail	Banquet	Height(m)
Dynasty (A+B+C)	2F	1,325	1,200	900	1,000	850	6.2
Marronnier	3F	105.2	120	60	150	70	2.8
Maple	3F	78	60	N/A	50	40	2.8
Lilac	3F	180	150	90	120	100	3.3
Orchid	23F	130	120	60	100	70	3.0
Pine	23F	55	-	-	30	24	3.0
Bamboo	23F	53	-	-	30	24	3.0
Plum	23F	53	-	-	30	24	3.0
Etoiles	23F	71.3	-	-	30	24	3.0
Prado	23F	54.9	-	-	30	16	3.0
Ruby	Yeong Bin Gwan	306	250	150	200	180	4.0
Topaz	Yeong Bin Gwan	259	250	140	180	150	4.0
Emerald	Yeong Bin Gwan	284	250	150	200	140	5.0

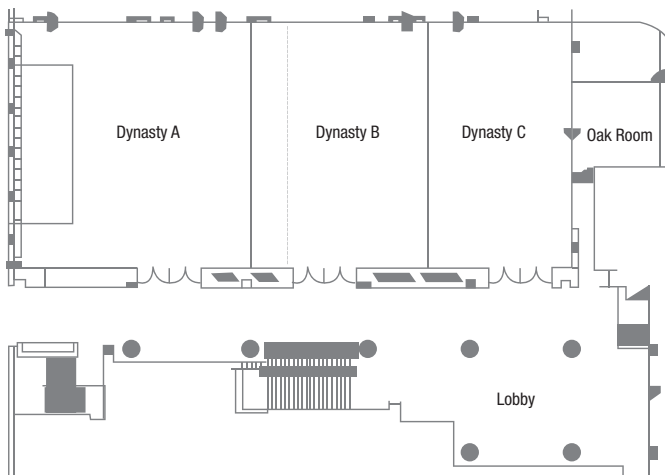

2F

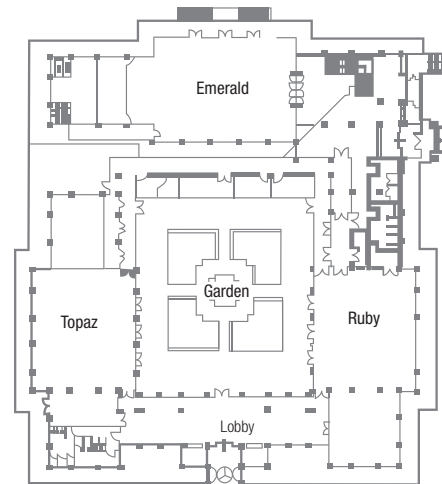

Yeong Bin Gwan

GUEST ROOMS

Room Type	Rooms
Superior	88
Deluxe	106
Grand Deluxe	157
Executive Grand Deluxe	86
The Korea	2
The Studio	12
The Premier	7
The Royal	2
The Presidential	2
Total	462
Single or Double	342
Twin	95
Suite	23

* Average Rates (Ordinary Rooms): KRW 200,000 - 310,000

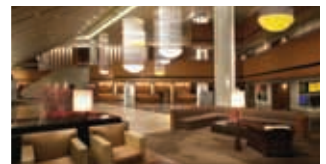

FOOD & BEVERAGE

Name of Facility	Location	Cuisine	Capacity
Cafe & Buffet	1F	-	214
Lounge & Main Bar	1F	-	160
Chinese Restaurant	2F	Chinese	167
Japanese Restaurant	2F	Japanese	93
European Restaurant	23F	European	120

Nearby Attractions

- **Shopping:** Shilla Duty Free Shop
- **Art & Museum:** Leeum (Samsung Museum of Art), National Museum of Korea
- **Sightseeing:** N Seoul Tower
- **Traditional Experience:** Namsangol Hanok Village, Korea House

> More info. p.146