

# Millennium Seoul Hilton

The Millennium Seoul Hilton is a super deluxe hotel nestled in the heart of Seoul. This 22-story business hotel offers refreshing facilities and exquisite services not to mention great views of Mt. Namsan. The hotel features 681 guest rooms, 9 restaurants, bars, a 24-hour casino and Clinique La Prairie SPA. In addition, the exquisite banquet hall promises graceful and refined services.

- Total area: 1,541m<sup>2</sup>
- No. of meeting rooms: 6
- Grade: SDL
- No. of guest rooms: 681
- Date of establishment: 1983
- From Incheon int'l Airport: 57min / 58.941 km
- A subway station: Line #1, 4 Seoul Station

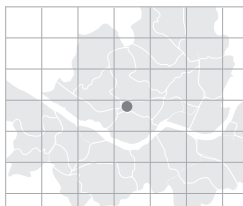

> Map: G-7 (p.019)



**Special Features** Situated on Mt. Namsan, the Millennium Seoul Hilton Hotel is close to the downtown area and only five minutes from Seoul Station and the nearest subway station. This location offers more favorable conditions for exhibition purposes. Also we undertake elaborate and customized event-planning activities-based on our many years of experience and skilled human resources-in consideration of your tastes and preferences as well as the purpose and nature of your event.

**Major Events** ★ICAO Asia & Pacific ADS-B Semianr (Incheon International Airport Corporation) - May. 2007 / 150guests ★Investigator Meeting (Bristol Meyer Squibb Com) - Jul. 2007 / 100guests ★The Church Growth International Conference (Church Growth International) - Oct. 2007 / 150guests ★FAWCO Conference (FAWCO) - Mar. 2008 / 200guests ★Intertech-PIRA Conference (Intertech-PIRA) - Jun. 2008/ 200guests ★VBWG Conference (VBWG) - Jul. 2008 / 150guests ★DLNA Plugfest (DLNA) - Jul. 2008/ 100guests ★The MBA Tour Fair (The MBA Tore ) - Aug. 2008 / 500guests ★Messe-Reisen Falk Gmbh Conference (Messe-Reisen Falk Gmbh) - Sep. 2008 / 200guests ★11th APEC Automotive Dialogue (KAMA) - Mar. 2009 / 120guests

PO Box 7692 Jungang, 395 Namdaemunno  
5-ga, Jung-gu, Seoul, Korea  
<http://www.hilton.co.kr>  
[webmaster@hilton.co.kr](mailto:webmaster@hilton.co.kr)  
Tel: 82-2-753-7788 Fax: 82-2-754-2510

---

Person in Charge\_Deepak SUBBAIAH  
Tel: 82-2-317-3210  
[Deepak.subbaiah@hilton.com](mailto:Deepak.subbaiah@hilton.com)



## MEETING & BANQUET FACILITIES

| Name of Hall   | Location | Size(m <sup>2</sup> ) | Theater | Classroom | Cocktail | Banquet | Height(m) |
|----------------|----------|-----------------------|---------|-----------|----------|---------|-----------|
| Grand Ballroom | LL       | 879                   | 850     | 450       | 1,000    | 450     | 6.9       |
| Kukhwa         | LL       | 264                   | 180     | 120       | 150      | 100     | 3.6       |
| Coral          | 3F       | 123                   | 80      | 50        | 80       | 60      | 2.8       |
| Jade           | 3F       | 110                   | 60      | 40        | 60       | 50      | 2.4       |
| Topaz          | 3F       | 94                    | 60      | 40        | 60       | 50      | 2.6       |
| Amber          | 3F       | 69                    | 50      | 30        | 50       | 40      | 2.8       |

### LL

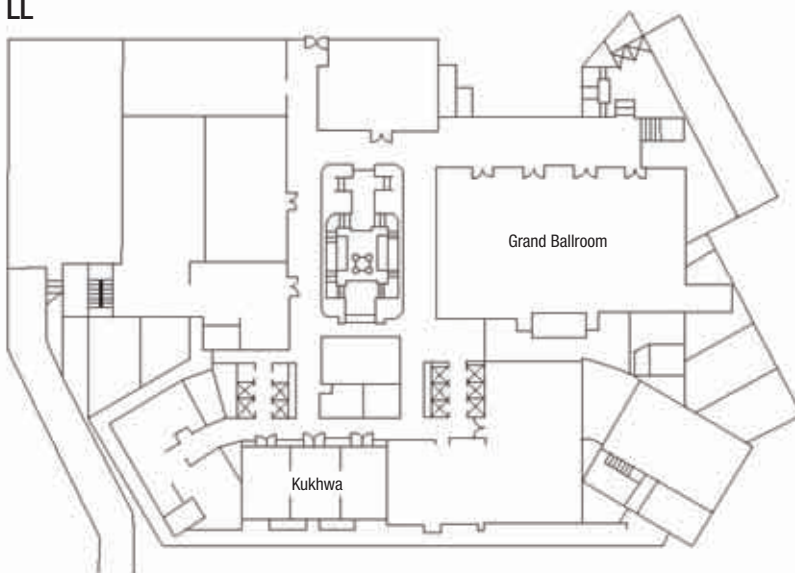

### GUEST ROOMS

| Room Type                      | Rooms      |
|--------------------------------|------------|
| Deluxe Room                    | 386        |
| Business Room                  | 62         |
| Executive Room                 | 140        |
| Executive "e" Room             | 63         |
| Junior Suite                   | 9          |
| Corner Suite                   | 9          |
| Korean Traditional Ondol Suite | 1          |
| Tower Suite                    | 2          |
| Premier Suite                  | 6          |
| Parkhill Suite                 | 1          |
| Vista Suite                    | 1          |
| Namdaemun Suite                | 1          |
| <b>Total</b>                   | <b>681</b> |
| Single or Double               | 438        |
| Twin                           | 243        |

\* Average Rates (Ordinary Rooms): KRW 330,000 - 380,000

### 3F

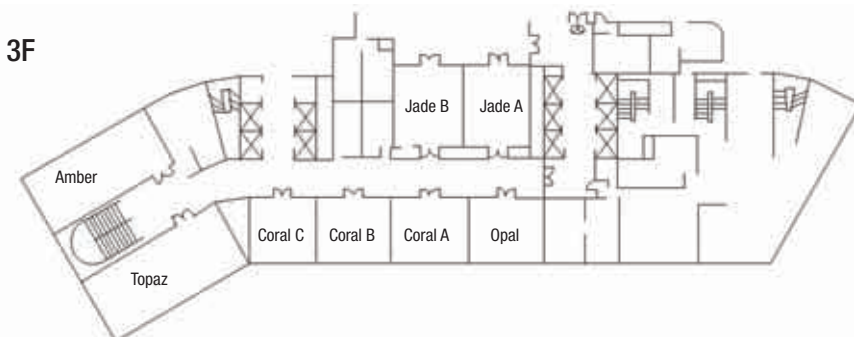

### FOOD & BEVERAGE

| Name of Facility | Location | Cuisine         | Capacity |
|------------------|----------|-----------------|----------|
| Cilantro         | Lobby    | Cafe's & Dining | 123      |
| Seasons          | Lobby    | French          | 75       |
| Palm Court       | Lobby    | Lobby Lounge    | 60       |
| Cilantro Deli    | Lobby    | Delicatessen    | -        |
| IL Ponte         | LL       | Italian         | 156      |
| Genji            | LL       | Japanese        | 90       |
| Taipan           | LL       | Chinese         | 84       |
| Oak Room         | LL       | Bar             | 85       |
| Orangerie        | 3F       | Buffet          | 280      |

### Nearby Attractions

- **Nightlife:** Sevenluck Casino
- **Shopping:** Lotte Duty Free Shop (Main Store)
- **Sightseeing:** N Seoul Tower
- **Traditional Experience:** Deoksugung Palace, Namsangol Hanok Village

> More info. p.146