

# Imperial Palace Hotel

Imperial Palace Hotel is a super deluxe hotel located in Gangnam, a hub of business and culture in Seoul. It offers 405 guest rooms, 13 restaurants and bars, a convention center which is capable of hosting 1,200 persons at a time and a fitness center. It was ranked top in Business Hotel sector at TIME Reader's Travel Choice Awards 2006.

- Total area: 2,037.5m<sup>2</sup>
- No. of meeting rooms: 11
- Grade: SDL
- No. of guest rooms: 405
- Date of establishment: 2005
- From Incheon int'l Airport: 57min. / 66.996 km
- A subway station: Line #7 Gangnam-gu Office Station

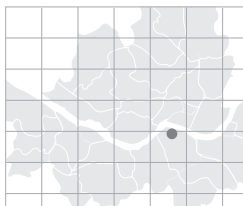

> Map: J-9 (p.019)



**Special Features** Convention halls upgrade your precious event's image through magnificent and dignified interior design, up-to-date facilities, convenient transportation & location, large parking lot and perfect preparation of advanced communication infra system. The two convention centers, magnificent and antique 'Dubhe' with a capacity of 1,000 persons and elegant and gorgeous 'Selena' with a capacity of 500 persons are the perfect places to hold an International Conference, Grand Seminar, Reception, Concert, Wedding Ceremony or family gatherings.

**Major Events** ★Korea Leadership Seminar (Korea Leadership Center) - Mar. 2008 / 500guests ★National Engineers' Day Awards (Korea Engineers Association) - Mar. 2008 / 350guests ★World Cosmetologists' Meeting (Korean Cosmetologists Association) - Jan. 2008 / 350guests ★The 10th Anniversary of the World Christian Tea-Culture Association (World Christian Tea-Culture Association) - May. 2009 / 300guests ★Annual Meeting of Korean Society of Environmental Health (Korean Society of Environmental Health) - Oct. 2009 / 300guests ★Annual Meeting of the Korean Society of Clinical Pathology (The Korean Society of Clinical Pathology) - Oct. 2009 / 500guests ★Korea Royal Costume Research Institute Fashion Show (Korea Royal Costume Research Institute) - Oct. 2009 / 500guests

248-7 Nonhyeon-dong, Gangnam-gu, Seoul, Korea

<http://www.imperialpalace.co.kr>

rsvn@iphotel.co.kr

Tel: 82-2-3440-8000 Fax: 82-2-3440-8200

Person in Charge LIM Jong-soo

Tel: 82-2-3440-8073

felix@iphotel.co.kr



## MEETING & BANQUET FACILITIES

Name of Hall	Location	Size(m <sup>2</sup> )	Theater	Classroom	Cocktail	Banquet	Height(m)
Dubhe I, II, III	7F	831.7	800	450	800	650	7
Selena I, II, III	7F	729	650	400	650	550	5.3
Phad	6F	102.1	70	40	70	60	3.5
Merak	6F	95.5	70	40	60	50	3.5
Megrez	6F	110.8	40	30	70	60	3.5
Alioth	6F	84.2	40	30	60	50	3.5
Mizar	6F	84.2	40	30	60	50	3.5

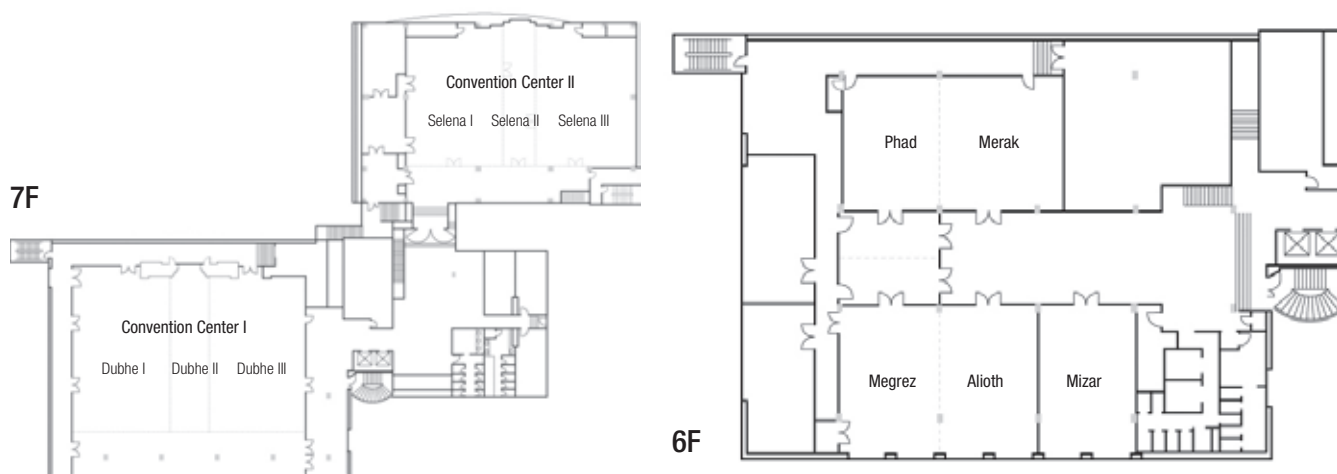

## GUEST ROOMS

Room Type	Rooms
Superior Room	168
Deluxe Room	138
Executive Club Floor Deluxe	53
Ondol Spa	11
Ondol Spa Suite	1
Executive Suite	6
Suite	5
Duplex Suite	14
Conner Suite	9
<b>Total</b>	<b>405</b>
Single or Double	271
Twin	134

## FOOD & BEVERAGE

Name of Facility	Location	Cuisine	Capacity
Zoe	B1	Bar	153
Members Bar	B1	Bar	90
Amador	1F	Deli	12
Verona	1F	Italian	58
Cafe's Amiga	1F	Cafe	158
The Bar	1F	Bar	58
Cheonsan	2F	Chinese	120
Manyo	2F	Japanese	130
Familia	2F	Buffet	230

\* Average Rates (Ordinary Rooms): KRW 150,000 -

## Nearby Attractions

- **Shopping:** The Galleria, Hyundai Department Store (Apgujeong)
- **Traditional Experience:** Bongeunsa Temple

\* A tour program offered by the hotel available (p. 154)

> More info. p.146