

Mayfield Hotel

Mayfield Hotel is a resort-like hotel in downtown. Many green facilities such as a grove, garden and promenade are available. With easy transportation, it is about 5 minutes away from Gimpo Airport and 30 minutes away from Incheon International Airport. It also takes about 30-60 minutes to go to major districts in Seoul. With perfect banquet facilities, it offers exquisite services.

- Total area: 105,785.6m²
- No. of meeting rooms: 13
- Grade: SDL
- No. of guest rooms: 182
- Date of establishment: 2003
- From Incheon int'l Airport: 42min / 43.296 km
- A subway station: Line #5 Gimpo Airport Station



> Map: A-7 (p.019)



Special Features A European-style deluxe hotel, Mayfield Hotel sits on a broad scenic site even though it is located in the city. This laidback and relaxing atmosphere makes Mayfield Hotel an ideal destination for businessmen and family tourists

Major Events [Corporate events] ★Team Managers' Leadership CAMP (LG Telecom) ★The 40th Anniversary Vision Declaration Ceremony (SHINHAN) ★Compass Meeting for the 1st Half of 2008 (SBS) ★The 20th Anniversary of ANA (ANA) ★H&FRIENDS GTL Group Vision Declaration 2008 (HFI) [Academic seminars] ★(Korea Civil Aviation Development Association (The Anniversary of Aviation Day 2008) ★ The Korean Society of Healthcare Pharmacists: Training Program for Middle-Management Leaders in the Hospital's Pharmacy Department ★Korea Institute of Registered Architects: The 14th National Female Architects Convention ★Australian Meat and Livestock Corporation (AMLC): Clean and Safe Australian Beef Grand Seminar 2008 ★Korea Machine Industry Promotion Association: DAEIL Plant Facility and Material Expo Fair 2007

426 Balsan-dong, Gangseo-gu, Seoul, Korea
<http://www.mayfield.co.kr>
mayfield@mayfield.co.kr
 Tel: 82-2-2660-9000 Fax: 82-2-2660-9001

Person in Charge_KIM Yeon-tae
 Tel: 82-2-2660-9151
ytkim@mayfield.co.kr



MEETING & BANQUET FACILITIES

Name of Hall	Location	Size(m ²)	Theater	Classroom	Cocktail	Banquet	Height(m)
Ballroom	Annex 1F	518	700	400	400	350	4.0
Ballroom I	Annex 1F	253	200	100	400	150	4.0
Ballroom II	Annex 1F	265	200	100	400	150	4.0
Orchid Room	Annex B1	415	300	200	500	250	3.0
Orchid Room I	Annex B1	162	70	70	200	70	3.0
Orchid Room II	Annex B1	100	50	40	100	50	3.0
Orchid Room III	Annex B1	152	70	60	200	70	3.0
Red Sun Room	Annex 3F	137	70	60	150	60	4.0
Blue Moon Room	Annex 2F	137	60	50	100	60	2.6
YI YUA'N Room	Annex 1F	188	90	90	200	80	3.2
The Lawn Garden	Outdoor	2,560	1,000	-	1,500	700	-
Atrium	Outdoor	902	600	-	700	300	-
Conference Room	Lobby	224	-	-	-	-	-

1F

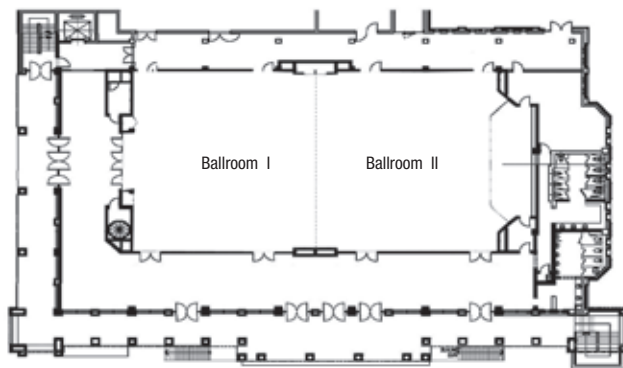

B1

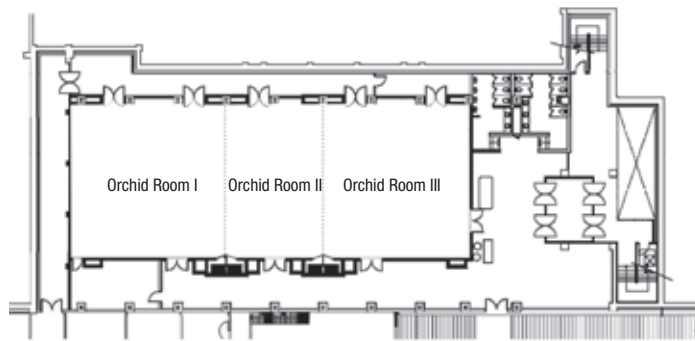

GUEST ROOMS

Room Type	Rooms
Standard Room	45
Superior Room	101
Ondol Room (Heated Floor)	2
Health Room	8
Deluxe Room	17
Business Suite	2
Honeymoon Suite	6
Presidential Suite	1
Total	182
Single	0
Double	30
Twin	143
Suite	9

* Average Rates (Ordinary Rooms): KRW 240,000

FOOD & BEVERAGE

Name of Facility	Cuisine	Capacity
Michelin	Buffet Restaurant	170
La Festa	Italian	65
YI YUAN	Chinese	70
Nakwon	Korean	240
Bongraejung	Traditional Korean	150
Royal Mile	Lounge & Coffee Shop	80
M Bar	Bar	-

Nearby Attractions

• **Street:** Hongik Univ. Street • **Nightlife:** Club M2, NB, Q-V0, Evans, WATERCOCK, FF, SPOT, Sound Holic • **Art & Museum:** Seodaemun Prison History Hall

* A variety of useful tourist materials are available in the lobby brochure rack

> More info. p.146