

The Ritz Carlton Seoul

The Ritz Carlton Seoul has a total of 375 guest rooms including 61 suites available in 11 different designs.

The hotel is unique in Seoul in that its rooms have balconies offering guests the chance to enjoy panoramic city views especially from spring to late autumn. The hotel also boasts a variety of banquet and meeting facilities that can accommodate up to 500 persons.

- Total area: 2,118m²
- No. of meeting rooms: 11
- Grade: SDL
- No. of guest rooms: 375
- Date of establishment: 1995
- From Incheon int'l Airport: 56min / 63.537 km
- A subway station: Line #2 Gangnam Station

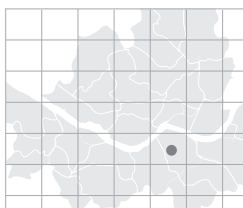

> Map: I-10 (p.019)



602 Yeoksam-dong, Gangnam-gu, Seoul, Korea

<http://www.ritzcarltonseoul.com>

info@ritzcarltonseoul.com

Tel: 82-2-3451-8000 Fax: 82-2-3451-8280

Person in Charge_KIM Do-yeon

Tel: 82-2-3451-8220

ian.kim@ritzcarlton.com

Special Features ① If you're looking for international designer labels, nearby Cheongdam-dong is the place to visit. Seoul's four most luxurious department stores are also nearby. Only 10 minutes away is the Coex convention center complex which includes both the Korea World Trade Center and a casino. ② The Ritz Carlton Seoul is easily accessible in a variety of ways including taxi, private car and bus. We also recommend utilizing Seoul's clean and efficient subways. Gangnam subway station, on Line 2, is only a three minute car trip or an easy eight minute walk. As of July 2009, with the opening of the Line 9 subway, the hotel's lobby will have direct subway access ③ From Gimpo International Airport it is only a 30 minute trip on Line 9 making staying at the Ritz-Carlton Seoul an obvious choice for international guests.

Major Events ★The 4th ASEAN + 3 New & Renewable Energy & Energy Efficiency & Conservation Forum (Korea Energy Management Corporation) - Mar. 2008 / 50guests ★Asian Economic Panel (Korea Institute for International Economic Policy) - Apr. 2008 / 50guests ★BDO (World Law Association / Korean Law Association) - May. 2008 / 150guests ★5th Renewable Energy & Distributed Generation (Korea Energy Management Corporation) - May. 2008 / 50guests

MEETING & BANQUET FACILITIES

Name of Hall	Location	Size(m ²)	Theater	Classroom	Cocktail	Banquet	Height(m)
Grand Ballroom	B3	672	800	550	1,000	550	6.5
Grand Ballroom 1	B3	336	300	260	400	260	6.5
Grand Ballroom 2	B3	336	300	260	400	260	6.5
Sorak	B3	247	140	110	200	110	2.4
Sorak 1	B3	120	70	50	100	60	2.4
Sorak 2	B3	105	70	50	100	50	2.4
Kumkang	B1	384	400	220	450	240	2.6
Kumkang 1	B1	120	90	50	100	60	2.6
Kumkang 2	B1	120	90	50	100	60	2.6
Kumkang 3	B1	120	90	50	100	60	2.6
Kumkang 4	B1	120	90	50	100	60	2.6
Calasia	3F	110	48	24	100	60	2.6

B1

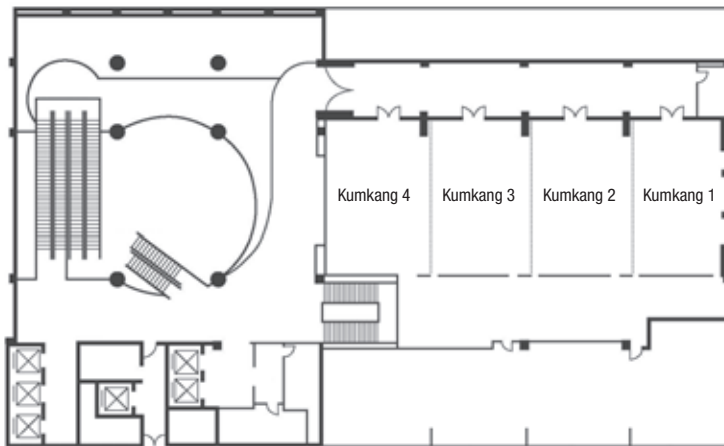

B3

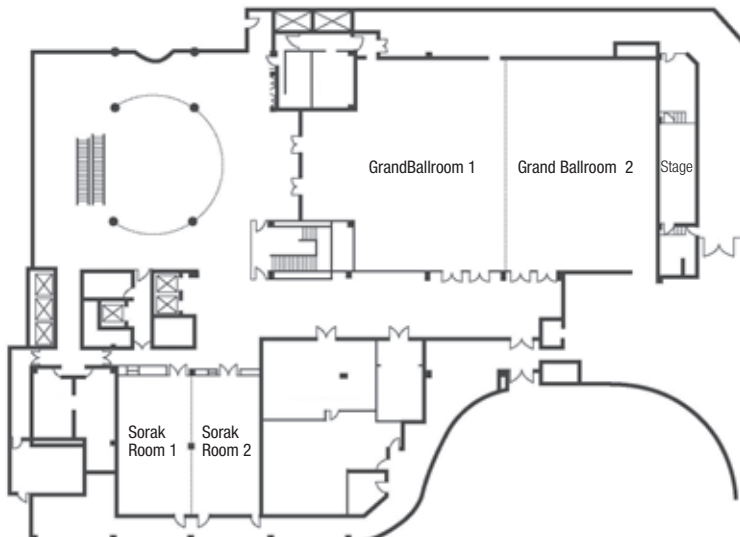

GUEST ROOMS

Room Type	Rooms
Superior Deluxe	230
Balcony Deluxe	24
Club Superior Deluxe	39
New Parlor Suite	21
New Club Parlor Suite	17
Premier Suite	27
Executive Suite	12
Ritz Carlton Suite	4
Presidential Suite	1
Total	375
Single or Double	304
Twin	71

* Average Rates (Ordinary Rooms): KRW 200,000 -

FOOD & BEVERAGE

Name of Facility	Location	Cuisine	Capacity
Garden	LL	Modern European	300
CheeHong	B2	Chinese	134
Caravali	B2	Bakery & Deli	62
The Ritz Bar	B2	Snacks & Drinks	110
Hanazono	B3	Japanese	104
Oksan Buffet	3F	International	320

Nearby Attractions

• **Shopping:** AK Duty Free Shop • **Entertainment:** LG Art Center • **Sightseeing:** Samsung d'light

* A tour program offered by the hotel available (p.155)

> More info. p.146