

Olympic Parktel

A beautiful youth hostel with a splendid view of Olympic Park and the Hangang River. It features a convention hall for an international conference and a large outdoor performance stage and offers delicious meals made from the freshest ingredients. In addition, other modern conveniences such as a sauna, fitness center and indoor golf driving range ensure comfort and relaxation.

- Total area: 25,055m²
- No. of meeting rooms: 15
- Grade: SDL Graded Youth Hostel
- No. of guest rooms: 233
- Date of establishment: 1990
- From Incheon int'l Airport: 62min / 73.315 km
- A subway station: Line #8 Mongchontoseong Station



> Map: M-9 (p.019)



88-8 Bangi-dong, Songpa-gu, Seoul, Korea
<http://www.parktel.co.kr>
parktel@kspo.or.kr
 Tel: 82-2-410-2114 Fax: 82-2-410-2101

Person in Charge_LEE Eun-jung
 Tel: 82-2-410-2514

Special Features Hangang Park, Lotte World Adventure, Prehistoric Cultural Remains and Coex are all within a 15 minutes drive from the hotel.

Major Events ★2008 Homecoming Program for Overseas Korean Youths - Jul. 2008 ★The General Meeting of Asian Youth Council - Jul. 2008 ★ The 10th Anniversary of Global Overseas Adoptees' Link (GOAL) - Aug. 2008 ★ International Convention of Girls' Friendly Society (by Anglican Church of Korea) Aug. 2008 ★Seoul INTEROTA 2008 - Aug. 2008 ★The 2nd International NGO Conference on Northeast Asian History - Oct. 2008

MEETING & BANQUET FACILITIES

Name of Hall	Location	Size(m ²)	Theater	Classroom	Banquet	Height(m)
Olympia Hall	1F	600	700	500	350	5.5
Seoul	2F	200	150	110	100	2.4
Tokyo	2F	240	100	80	80	2.4
London	2F	150	100	60	60	2.4
Rome	2F	60	40	30	20	2.4
Paris	2F	53	40	30	20	2.4
Beijing	2F	53	40	30	20	2.4
Helsinki	2F	27	-	-	10	2.4
Athens	4F	200	150	110	100	2.4
Berlin	4F	150	100	60	60	2.4
Atlanta	4F	60	40	30	20	2.4
Montreal	4F	53	40	30	20	2.4
Sydney	4F	60	40	30	20	2.4
Moscow	4F	60	40	30	20	2.4
Calgary	4F	43	20	18	12	2.4

4F

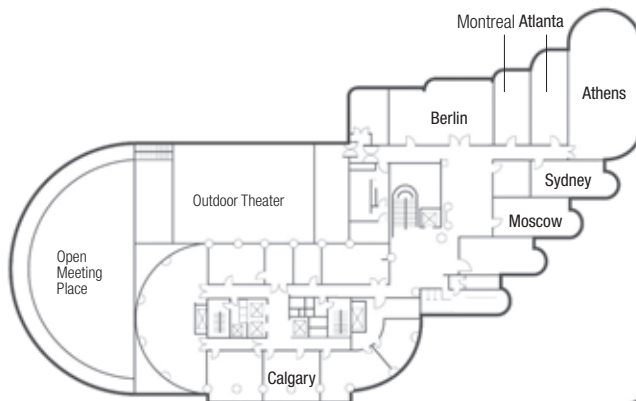

2F

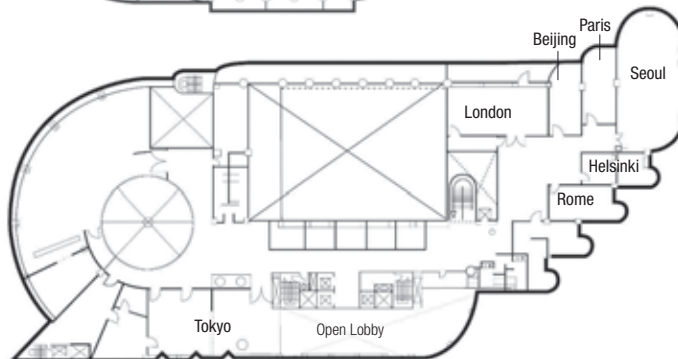

1F

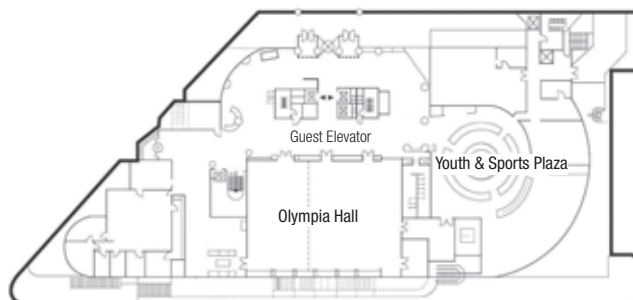

GUEST ROOMS

Room Type	Rooms
Youth Room (Suite)	8
Family Room	40
Twin Room	123
Double Room	9
Korean Ondol (Heated Floor)	5
Bunk Bed	48
Total	233
Double	9
Twin	123
Suite	8
Others (Korean Ondol, Family, Bunk)	93

* Average Rates (Ordinary Rooms): KRW 187,000

FOOD & BEVERAGE

Name of Facility	Cuisine	Capacity
Youth & Sports Plaza	Coffee & Western Food	200
Airang	Korean	200
Sky Park	Buffet	240
Baekjegwan	Korean	140

Nearby Attractions

- **Shopping:** Lotte Duty Free Shop (Lotte World)
- **Sightseeing:** Olympic Park, SOMA Museum of Art

> More info. p.146