

# The Lexington Hotel

The Lexington Hotel serves the top executives of the business world. Located in Yeouido, a trend setting headquarters and business center, the Lexington provides you a place where you can truly be a part of it all. The first New York concept Business Hotel in Seoul, the Lexington Hotel is located only 45 minutes away from Incheon International Airport while offering breathtaking views of Yeouido Park and the Hangang River. The Lexington Hotel not only has the business culture of New York's Manhattan, but with an authentic Korean flair for service that makes for a truly special Seoul experience.

- Total area: 22,133.60m<sup>2</sup>
- No. of meeting rooms: 12
- Grade: DLX
- No. of guest rooms: 232
- Date of establishment: 1978
- From Incheon int'l Airport: 45min / 52.767 km
- A subway station: Line #5 Yeouinaru Station

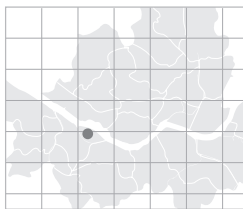

> Map: E-8 (p.019)



13-3 Yeouido-dong, Yeongdeungpo-gu, Seoul, Korea

<http://www.thelexington.co.kr>  
webmaster@thelexington.co.kr

Tel: 82-2-6670-7000 Fax: 82-2-6670-7299

Person in Charge\_JUNG Sul-hyun  
Tel: 82-2-6670-7333  
jsh78@leisure.com

**Special Features** ① 14th floor: Seven meeting rooms with capacity for 3 to 18 guests ② Screen and white board available in the banquet hall ③ Sound systems and microphone available in the banquet hall ④ Beam Projector: KRW 150,000 for rent / LAN: KRW 20,000 per port (free wireless LAN available) ⑤ Copy - 150 per page/ Print Out - ₩500 per page ⑥ 10% VAT will be additionally charged to all bills in the hotel. No service fee will be charged (zero rate is applied to foreigners)

**Major Events** ★RCC Seminar for Competition Authorities (OECD) ★Meeting on A.B.U. Copyright Organized by MBC (MBC) ★Unofficial Seminar by Environmental Management Corporation ★Events Associated with National Assembly and Government Organizations ★Seminar by Private Companies (Samsung SDI, LG Philips LCD, LG Electronics, Alcon Korea, Costco Korea, etc.)



### MEETING & BANQUET FACILITIES

Name of Hall	Location	Size(m <sup>2</sup> )	Theater	Classroom	Cocktail	Banquet	Height(m)
Central Park	15F	280.1	300	230	350	140	3.1
Grand Station	15F	191.09	150	96	200	80	3.1
Union Square	15F	142.59	120	84	150	60	3.1
Chelsea	2F	127.3	80	60	70	50	2.9
Greenwich	2F	80.36	35	27	40	-	2.9

15F

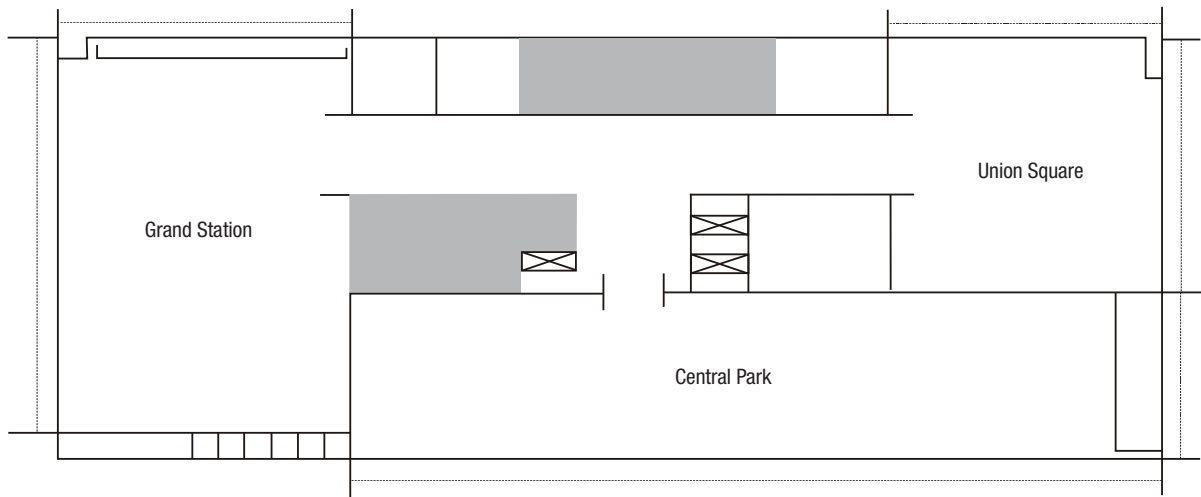

### GUEST ROOMS

Room Type	Rooms
Double	58
Twin	161
Suite	6
Others (Korean Ondol)	7
<b>Total</b>	<b>232</b>

### FOOD & BEVERAGE

Name of Facility	Location	Cuisine	Capacity
Broadway	1F	Buffet	100
New York New York	1F	Western	60
Little Tokyo	2F	Japanese	80
China Town	2F	Chinese	80
Yanks & Mettz	2F	Lounge/Bar	80

\* Average Rates (Ordinary Rooms): KRW 215,000 - 233,000

### Nearby Attractions

> More info. p.146

• **Shopping:** I'PARK Mall, Yongsan Electronics Mall Complex • **Art & Museum:** National Museum of Korea • **Sightseeing:** The War Memorial of Korea

\* Reservation of tour packages (ex: Seoul Tour, DMZ Tour, etc.) for customers